

FIMEC[®]

High Tech Made in Italy



HIGH FREQUENCY SPINDLE MOTORS

Fimec spindle motors are designed to produce high torque and high speeds in compact dimensions. This makes the motor ideal for machining wood, plastics, aluminium, marble and glass for use in jobs ranging from routing, drilling and sawing to cutting, boring and grinding. Cooling is provided by a proprietary fan which rotates at spindle speed or, on request, by an electric fan independent from motor speed (separate electric fan warrants cooling at speeds lower than 7000rpm and for noiseless workings at the highest speeds).

These motors also include a labyrinth sealing arrangement to virtually eliminate any possibility of foreign particles damaging the bearings.

Fimec spindle motors are available with keyed or collet shaft.

Motors with keyed and threaded shaft (type L) mount a single deep groove spindle bearing at both ends of the housing. In this case, the motor can accept light plunge cutting, inducing axial loads but it is more suitable for those applications mainly involving radial loads.

Motors with collet shaft (type P) mount a double angular contact thrust bearing at the work end, with a single deep groove support bearing at the opposite end. They are designed for those applications requiring heavy plunge cutting, inducing high axial loads, on a regular basis.

Variable frequency drive is supplied on request.

SPINDLE MOTORS WITH KEYED SHAFT

	Motor Type	Power (S1)	Max. Speed (Rpm)	Voltage	Fixing	Connection type	Cable Exit
55	HT55a-090L	0.65 kw	12000	380V	Lateral (left & right)	Connector	Rear
	HT55b-090L	0.65 kw	12000	380V	Lateral (left & right)	Connector	Rear + rotating connector
	HT55c-090L	0.65 kw	12000	380V	Bottom	Connector	Front

73	HT73a-030L	0.5 kw	12000	380V	Bottom	Terminal box	Front
	HT73a-045L	0.75 kw	12000	380V	Bottom	Connector	Front
	HT73a-060L	1 kw	12000	380V	Lateral Left & Right	Connector	Rear
	HM73a-120L	2 kw	12000	380V	Lateral Left & Right	Connector	Rear

90	HT90a-100L	3.5kw	12000	380V	Lateral Left & Right	Connector	Rear + rotating connector
	HM90a-140L	5 kw	12000	380V	Bottom Fixing	Connector	Front
	HM90b-140L	5 kw	12000	380V	Lateral Left & Right and Bottom	Connector	Front

120	HT120b-170L	8.1 kw	6000	380V	Lateral Left & Right and Bottom	Terminal box	Front
	HT120a-170L	5.8 kw	6000	380V	Lateral Left & Right and Bottom	Terminal box	Front
	HT120a-170L	11 kw	6000	380V	Lateral Left & Right and Bottom	Terminal box	Front

DIMENSIONS

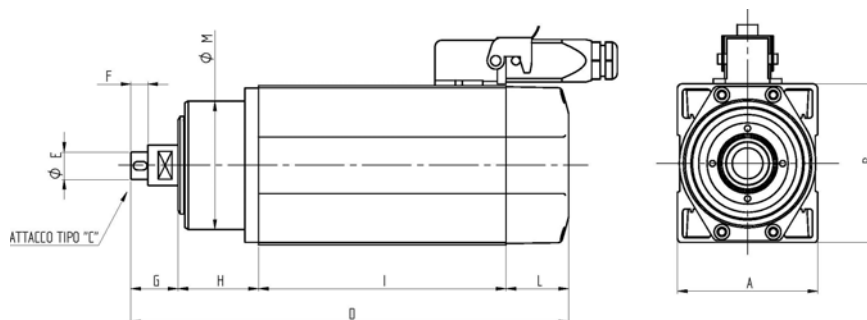

	A	B	C	D	E	F	G	H	I	L	M
55-090	73	70	Keyed	237,5	16	10	26	29,5	153	29	56
73-030	82	93	Keyed	151,5	16	5,5	6,5	25,5	83	36,5	75
73-045	82	93	Keyed	190	16	15	16	25,5	112	36,5	75
73-060	82	93	Keyed	255,5	16	10	27,5	47	144,5	36,5	75
73-120	82	93	Keyed	325,5	16	10	27,5	47	214,5	36,5	75
90-100	103	120	Keyed	330	30	64	76,5	26,5	181	46	85
90-140	103	120	Keyed	392,5	30	64,5	77	48,5	221	46	85
120-170	177	145	Keyed	490	40	80	80	55	300	55	120

SPINDLE MOTORS WITH COLLET SHAFT

	Motor Frame	Shaft	Voltage	Rotation	Max Speed rpm	kw	Fixing	Connection	Cable Exit
55	HM55a-090	ER20	380V	Right	12/12000	0,65	Bottom Fixing	Connector	Front
	HM55d-090	ER20	380V	Right	18/24000	1,00	Bottom Fixing	Connector	Front
	HM55a-090	ER20	220V	Right	12/12000	0,65	Bottom Fixing	Connector	Front
	HM55d-090	ER20	220V	Right	18/24000	1,00	Bottom Fixing	Connector	Front

73	HM73a-060	ER25	380V	Right	12/12000	1,00	Bottom Fixing	Connector	Rear
	HM73b-060	ER25	380V	Right	18/18000	1,50	Bottom Fixing	Connector	Rear
	HM73d-060	ER25	380V	Right	18/24000	1,50	Bottom Fixing	Connector	Rear
	HM73a-060	ER25	220V	Right	12/12000	1,00	Bottom Fixing	Connector	Rear
	HM73b-060	ER25	220V	Right	18/18000	1,50	Bottom Fixing	Connector	Rear
	HM73d-060	ER25	220V	Right	18/24000	1,50	Bottom Fixing	Connector	Rear
	HM73a-120	ER25	380V	Right	12/12000	2,00	Bottom Fixing	Connector	Rear
	HM73b-120	ER25	380V	Right	18/18000	3,00	Bottom Fixing	Connector	Rear
	HM73d-120	ER25	380V	Right	18/24000	3,00	Bottom Fixing	Connector	Rear
	HM73a-120	ER25	220V	Right	12/12000	2,00	Bottom Fixing	Connector	Rear
	HM73b-120	ER25	220V	Right	18/18000	3,00	Bottom Fixing	Connector	Rear
	HM73d-120	ER25	220V	Right	18/24000	3,00	Bottom Fixing	Connector	Rear

90	HM90a-100	ER32	380V	Right	12/12000	3,50	Bottom Fixing	Connector	Front
	HM90b-100	ER32	380V	Right	18/18000	4,50	Bottom Fixing	Connector	Front
	HM90d-100	ER32	380V	Right	18/24000	4,50	Bottom Fixing	Connector	Front
	HM90a-100	ER32	220V	Right	12/12000	3,50	Bottom Fixing	Terminal Box	Front
	HM90b-100	ER32	220V	Right	18/18000	4,50	Bottom Fixing	Terminal Box	Front
	HM90d-100	ER32	220V	Right	18/24000	4,50	Bottom Fixing	Terminal Box	Front
	HM90a-140	ER32	380V	Right	12/12000	5,00	Bottom Fixing	Connector	Front
	HM90b-140	ER32	380V	Right	18/18000	6,00	Bottom Fixing	Connector	Front
	HM90d-140	ER32	380V	Right	18/24000	6,00	Bottom Fixing	Connector	Front
	HM90a-140	ER32	220V	Right	12/12000	5,00	Bottom Fixing	Terminal Box	Front
	HM90b-140	ER32	220V	Right	18/18000	6,00	Bottom Fixing	Terminal Box	Front
	HM90d-140	ER32	220V	Right	18/24000	6,00	Bottom Fixing	Terminal Box	Front

120	HM120-170	ER40	380V	Right	12/18000	13,50	Bottom Fixing	Terminal Box	Front
	HM120-170	ER40	380V	Right	6/6000	8,10	Bottom Fixing	Connector	Front
	HM120-170	ER40	380V	Right	12/18000	13,50	Lateral Right side fixing	Connector	Front

DIMENSIONS

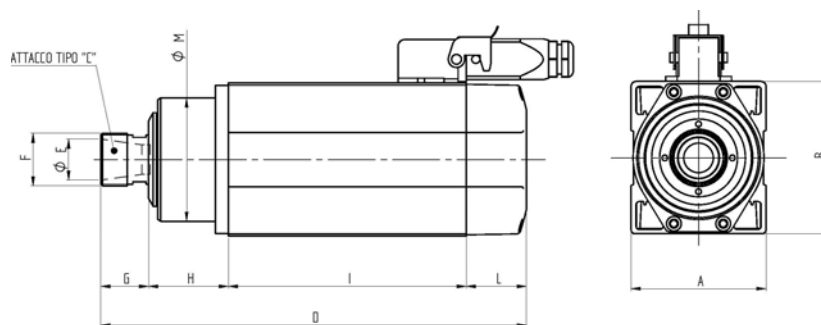

	A	B	C	D	E	F	G	H	I	L	M
55-090	70	72	ER20	251	20	M25x1,5	27,5	41,5	153	29	56
73-060	82	93	ER25	258,5	25	M32x1,5	29	48,5	144,5	36,5	75
73-120	82	93	ER25	328,5	25	M32x1,5	29	48,5	214,5	36,5	75
90-100	103	120	ER32	310,5	32	M40x1,5	35	48,5	181	46	85
90-140	103	120	ER32	350,5	32	M40x1,5	35	48,5	221	46	85
120-170	177	145	ER40	454,5	40	M50x1,5	38	61,5	300	55	120

SPINDLE MOTORS WITH COLLET SHAFT AND ELECTRIC FAN

	Motor Frame	Shaft	Voltage	rpm	Power S1 kw	Fixing	Connection	Cable exit
1073	HM73d-120-EL	ER25	220V	18/24000	2,10	Bottom	Connector	Rear
	HM73d-120-EL	ER25	380V	18/24000	2,10	Bottom	Connector	Rear

1090	HM90d-100-EL	ER32	380V	18/24000	2,50	Bottom	Connector	Front
	HM90d-140-EL	ER32	380V	18/24000	3,90	Bottom	Connector	Front

120	HM120d-170EL	ER40	380V	12/12000	13,5 (S6 60%)	Lateral left & Right Fixing	Connector	Front
-----	--------------	------	------	----------	------------------	--------------------------------	-----------	-------

DIMENSIONS

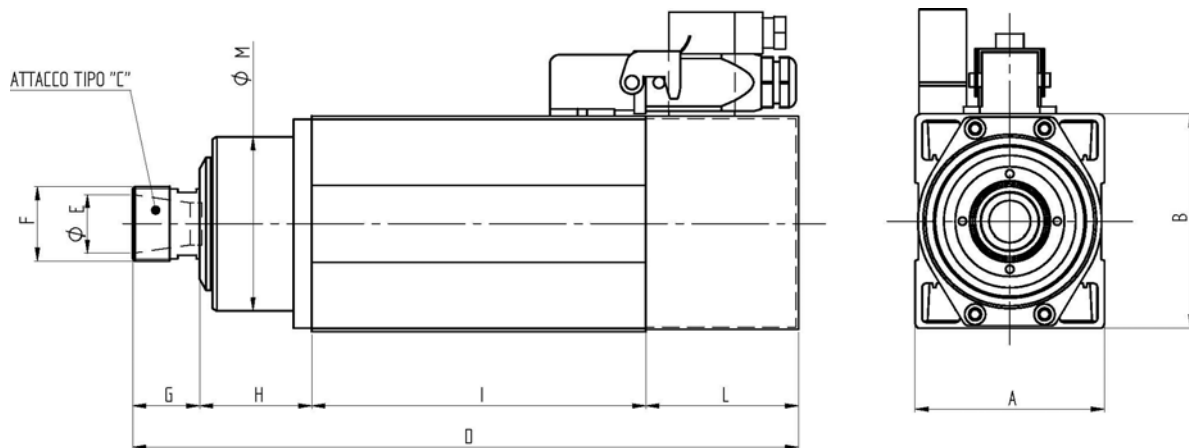

	A	B	C	D	E	F	G	H	I	L	M
73-060	82	93	ER25	288	25	M32x1,5	29	48,5	144,5	66	75
73-120	82	93	ER25	358	25	M32x1,5	29	48,5	214,5	66	75
90-100	103	120	ER32	347,5	32	M40x1,5	35	48,5	181	83	85
90-140	103	120	ER32	387,5	32	M40x1,5	35	48,5	221	83	85
120-170	177	145	ER40	481,5	40	M50x1,5	38	61,5	300	82	120

[Contact us for the complete catalogue of our spindle motors](#)

FIMEC[®]
S.p.A.

Via Carpi – Ravarino 336 41010 Limidi (Modena) Italy

Tel. + 39 059/561617 561604 – Fax. +39- 059/565309 – www.fimec.it email: info@fimec.it